

# 8325 Lemont Road

DARIEN, IL 60561

# Sublease

RETAIL SPACE



- ▶ 13,435 SF available
- ▶ Located at the highly trafficked southeast corner of Lemont & 83rd Street
- ▶ Large signage opportunity available
- ▶ Ample parking
- ▶ Area tenants include Walgreens, The Goddard School and more

## DEMOGRAPHIC SUMMARY

	1 Mi	3 Mi	5 Mi
Estimated Population	8,156	88,153	217,070
Adj. Daytime Demographics	7,597	76,053	198,400
Estimated Households	3,253	34,885	86,204
Estimated Average Household Income	\$160,274	\$126,264	\$133,692

### DOUG RENNER

doug.renner@baumrealty.com  
312.275.3137

### MARK FREDERICKS

mark@baumrealty.com  
312.275.3109



© 2022 All information supplied is from sources deemed reliable and is furnished subject to errors, omissions, modifications, removal of the listing from sale or lease, and to any listing conditions, including the rates and manner of payment of commissions for particular offerings, the terms of which are available to principals or duly licensed brokers. Any square footage dimensions set forth are approximate.

# 8325 Lemont Road

DARIEN, IL 60561

# Sublease

RETAIL SPACE

## SITE PLAN

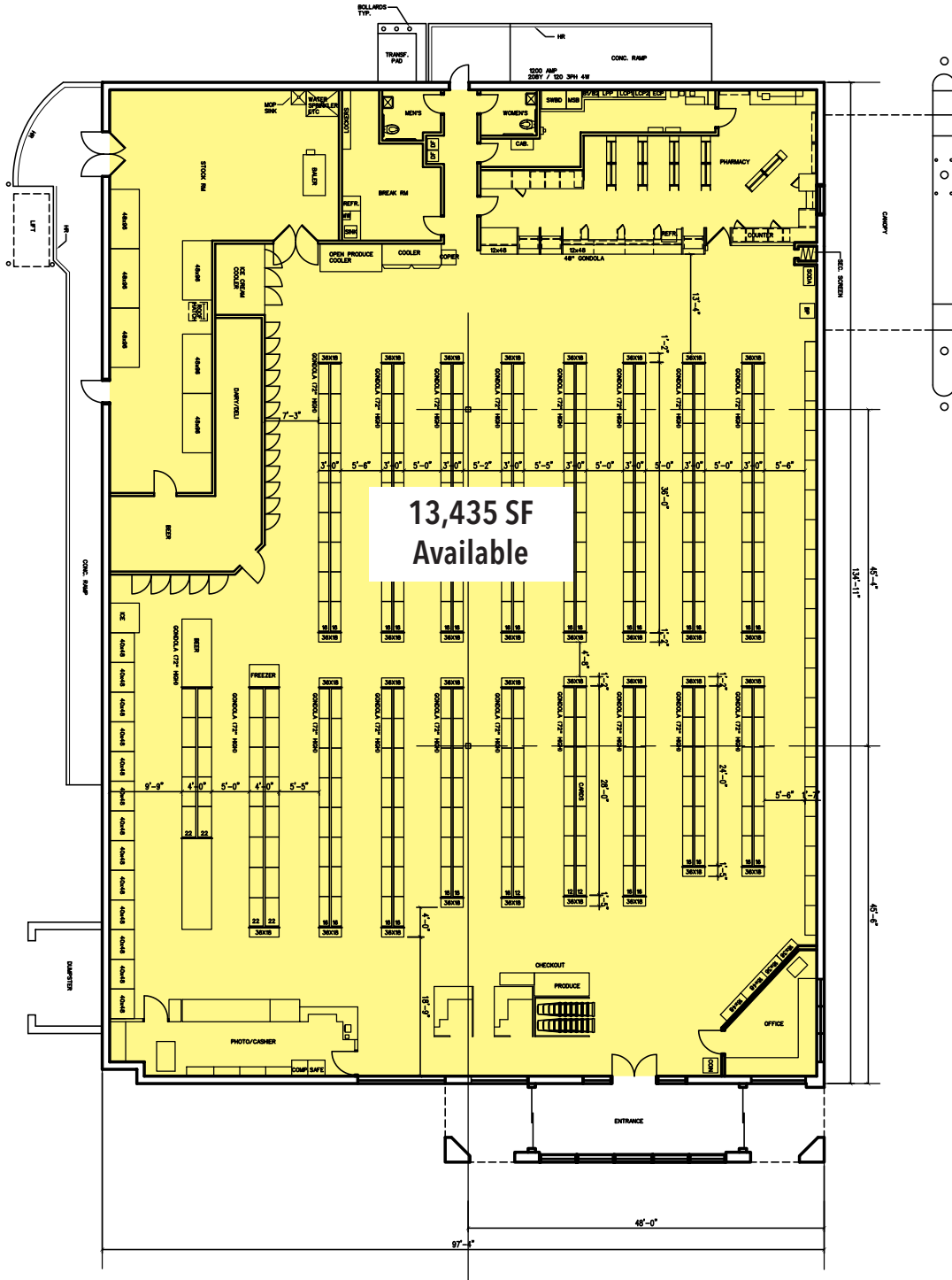

**DOUG RENNER**  
doug.renner@baumrealty.com  
312.275.3137

**MARK FREDERICKS**  
mark@baumrealty.com  
312.275.3109



© 2022 All information supplied is from sources deemed reliable and is furnished subject to errors, omissions, modifications, removal of the listing from sale or lease, and to any listing conditions, including the rates and manner of payment of commissions for particular offerings, the terms of which are available to principals or duly licensed brokers. Any square footage dimensions set forth are approximate.

8325 Lemont Road  
Darien, IL

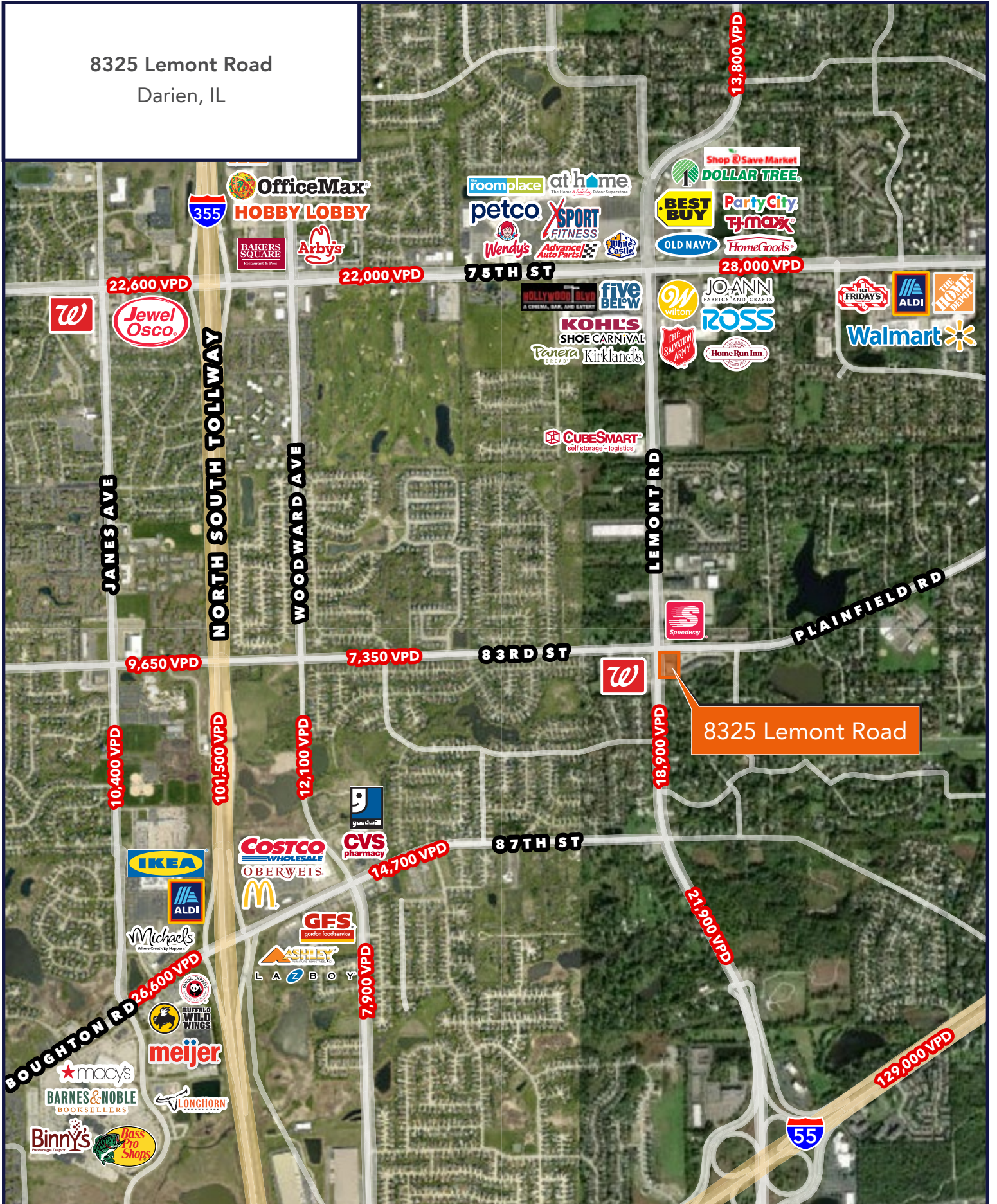

8325 Lemont Road