

An architectural rendering of a modern, multi-story building with a grid-like facade of windows. A vertical sign on the left side of the building reads "THE FIELDS". The scene is set at dusk or dawn, with a warm, reddish-pink color palette. The building has a prominent entrance on the ground floor with the address "4000" above it. People are walking on the sidewalk, and cars are parked or driving on the street. The overall atmosphere is urban and contemporary.

THE FIELDS

RETAIL AVAILABILITIES

KNICKPOINT
VENTURES





ABOVE: RETAIL CORRIDOR, BELOW: D2 ROOF DECK

Available Retail Space

Suites ranging from 700-30,000RSF

KEY FEATURES:

- Dedicated and/or shared loading docks
- Plentiful indoor and outdoor parking on site
- 14-18' Ceiling Heights
- High volume grocery store on site and 123 occupied residential units drives consumer traffic

GROUND FLOOR RETAIL PLAN (CONCEPTUAL)

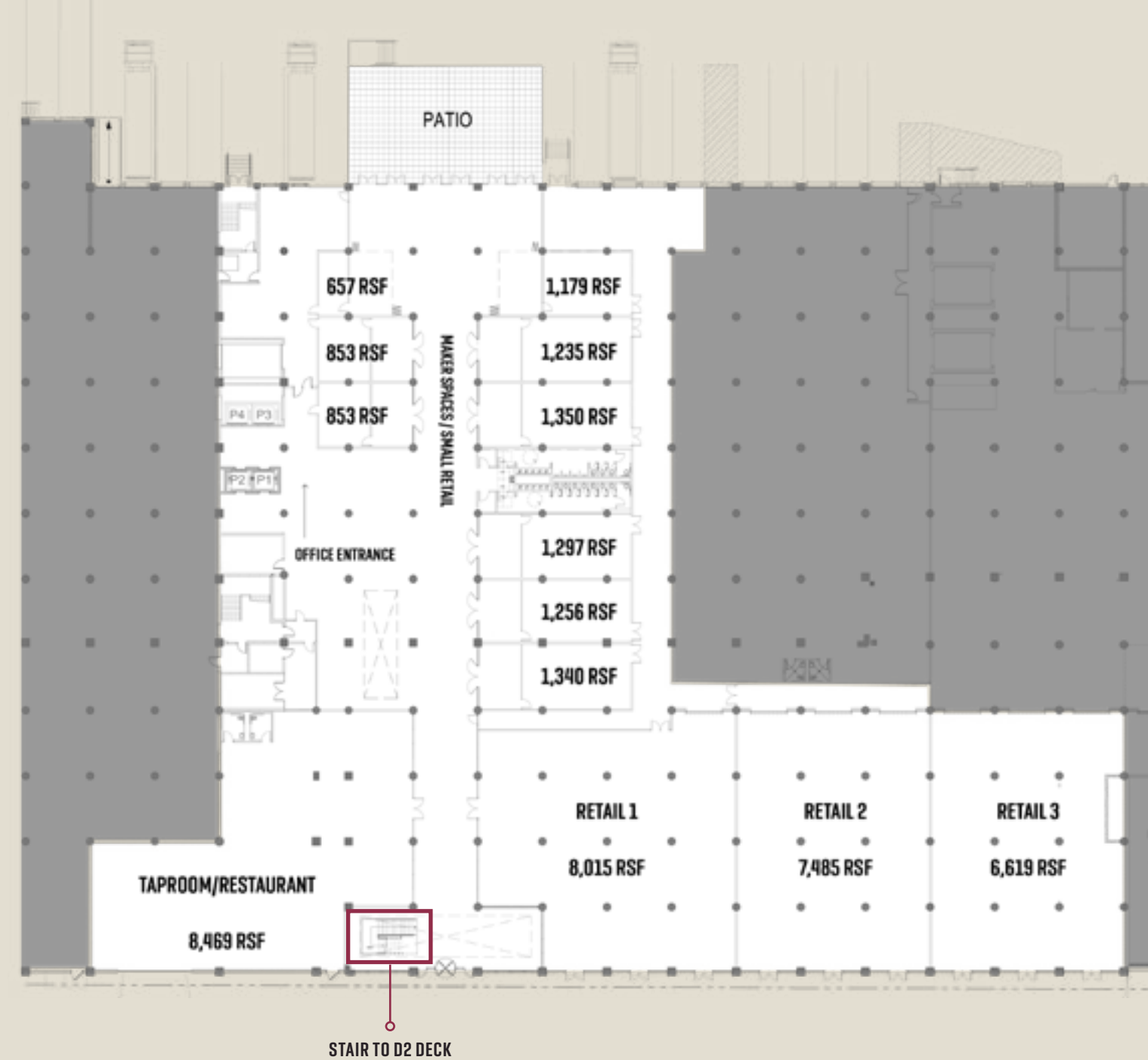

STOREFRONT DESIGN



Learn More About The Fields

ARI TOPPER

ARI@BAUMREALTY.COM

SHEILAH CARROLL

SHEILAH@KNICKPT.COM

TheFieldsChicago.com