

For Lease

Retail Space

222 S. Riverside Plaza

Chicago, IL 60606 | West Loop



- Rare West Loop retail opportunity with massive outdoor patio
- Up to 4,633 SF retail space
- Courtyard to be renovated providing abundant signage and visibility
- Retail space in 1 million square foot office building
- Great location adjacent to Union Station
- With convenient access to public transportation and central downtown, the West Loop is a hot bed of new development with a growing working population
- Area retailers include Starbucks, Potbelly, Target, Mariano's, Whole Foods, Chase, Bank of America and many more nationally recognized brands

DEMOGRAPHIC SUMMARY

	RADIUS		
	.25 MILE	.50 MILE	1 MILE
AVERAGE HHI	\$99,812	\$105,295	\$118,617
DAYTIME POPULATION	58,571	218,751	470,313
RESIDENTIAL POPULATION	4,119	12,067	48,578

On behalf of

Deutsche Asset
& Wealth Management



Doug Renner
312.275.3137
doug.renner@baumrealty.com

Allen Joffe
312.275.3120
allen@baumrealty.com



For Lease

Retail Space

222 S. Riverside Plaza

Chicago, IL 60606 | West Loop

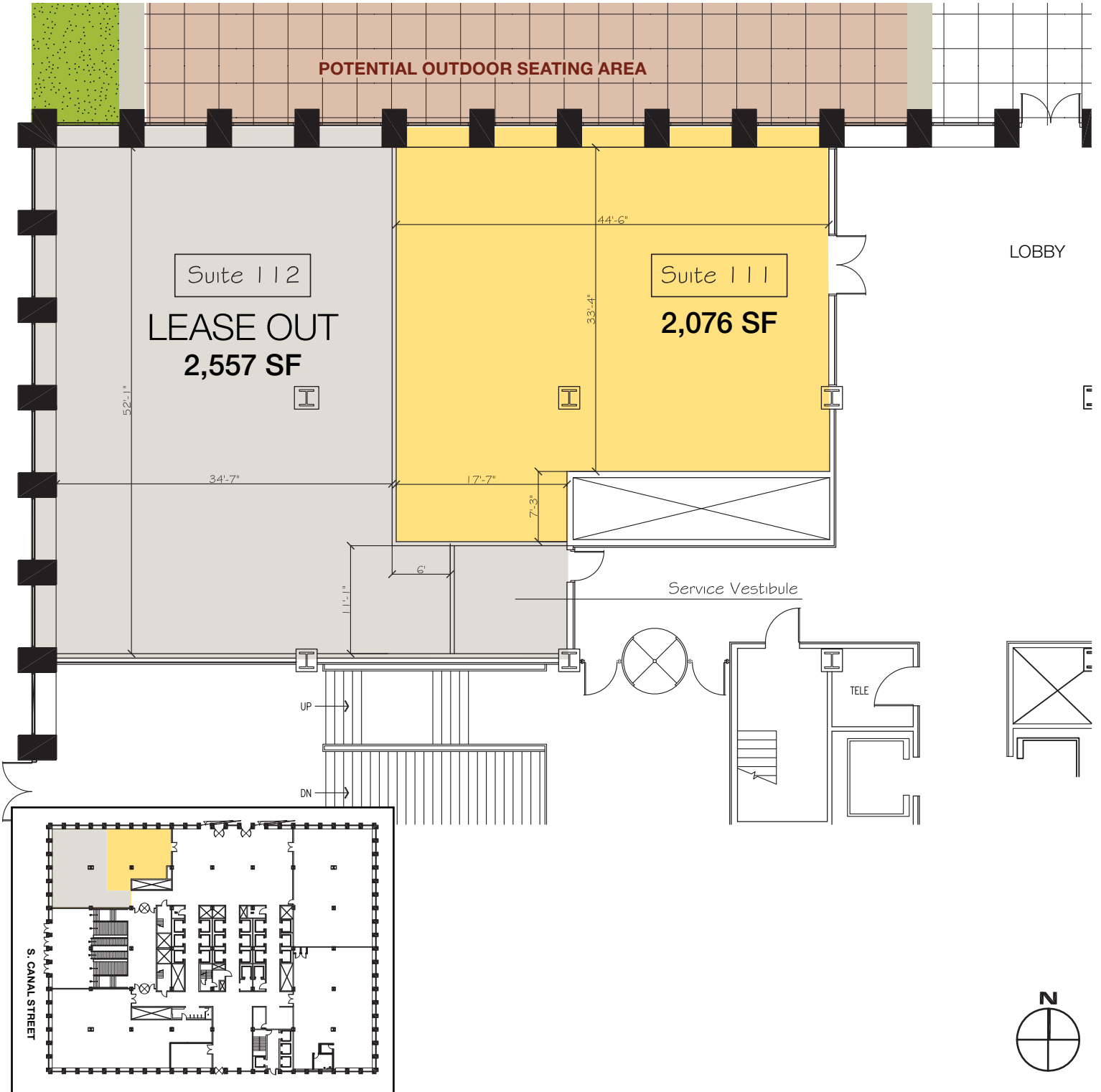

Doug Renner
312.275.3137
doug.renner@baumrealty.com

Allen Joffe
312.275.3120
allen@baumrealty.com



