

For Lease

Retail Space

3208 N. Sheffield Avenue

Chicago, IL 60657 | Lakeview



- 1,089 SF vanilla box available
- Located in a dense, high income area in the heart of Lakeview
- Around the corner from the Belmont Red Line CTA stop
- Neighboring tenants include Walgreens, Bank of America, Native Foods Café, Blaze Pizza, Einstein Bros. Bagels and The Vic Theatre
- Lease out with a local cafe in the building

DEMOGRAPHIC SUMMARY

	RADIUS		
	.25 MILE	.5 MILE	1 MILE
AVERAGE HHI	\$145,135	\$143,368	\$121,517
DAYTIME POPULATION	7,870	16,061	55,114
RESIDENTIAL POPULATION	6,213	23,247	99,259

TRAFFIC COUNTS

BELMONT AVENUE	18,600 VPD
SHEFFIELD AVENUE	8,600 VPD

Doug Renner
312.275.3137
doug.renner@baumrealty.com

Trevor Jack
312.275.3128
trevor@baumrealty.com



For Lease

Retail Space

3208 N. Sheffield Avenue

Chicago, IL 60657 | Lakeview

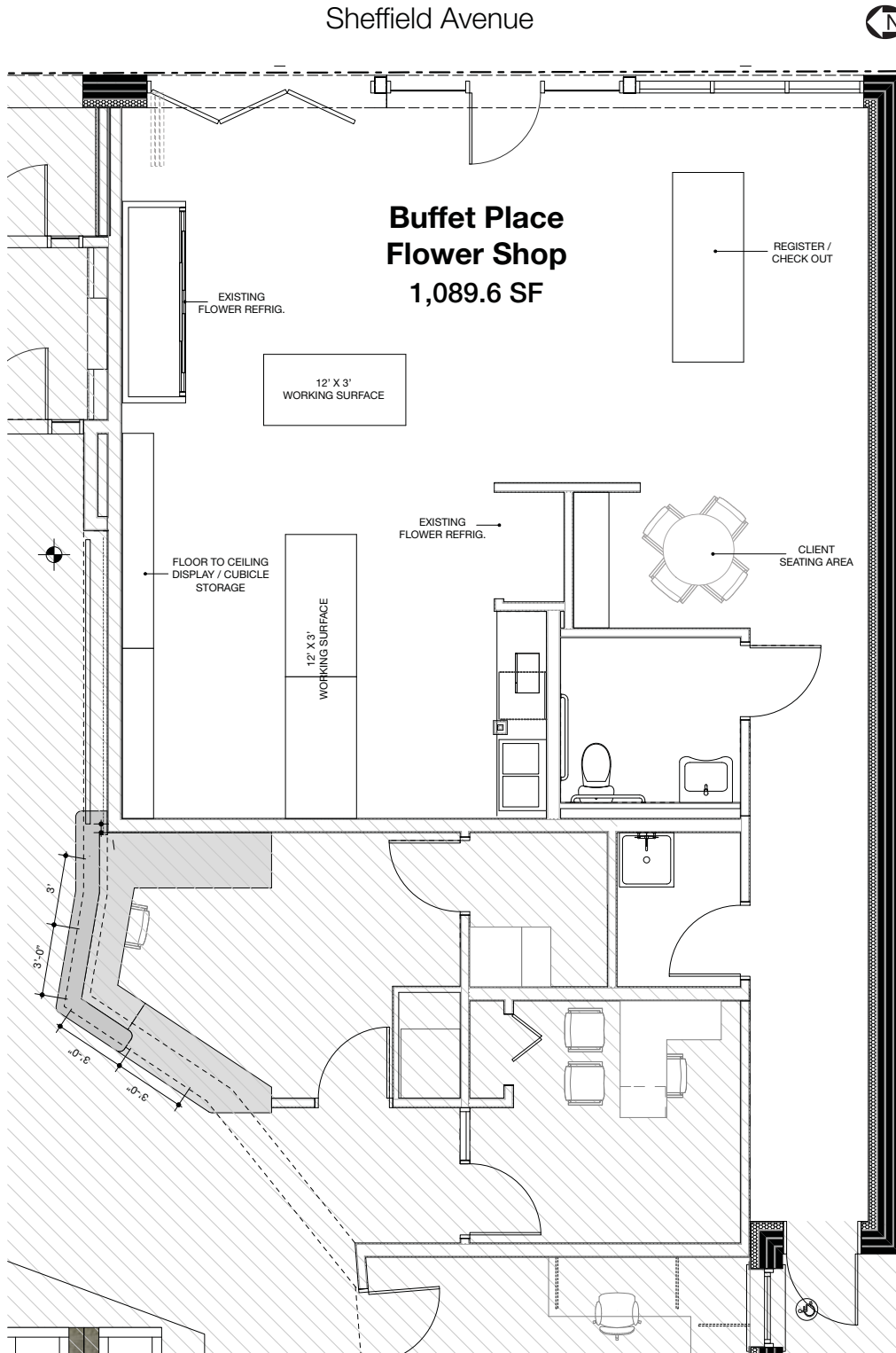

Doug Renner
312.275.3137
doug.renner@baumrealty.com

Trevor Jack
312.275.3128
trevor@baumrealty.com



