

5601 W. Belmont Avenue

CHICAGO, IL 60634 | BELMONT-CRAGIN

For Lease

RETAIL SPACE

HIGHLY VISIBLE RETAIL LOCATION AT THE CORNER OF BELMONT AVENUE & CENTRAL AVENUE

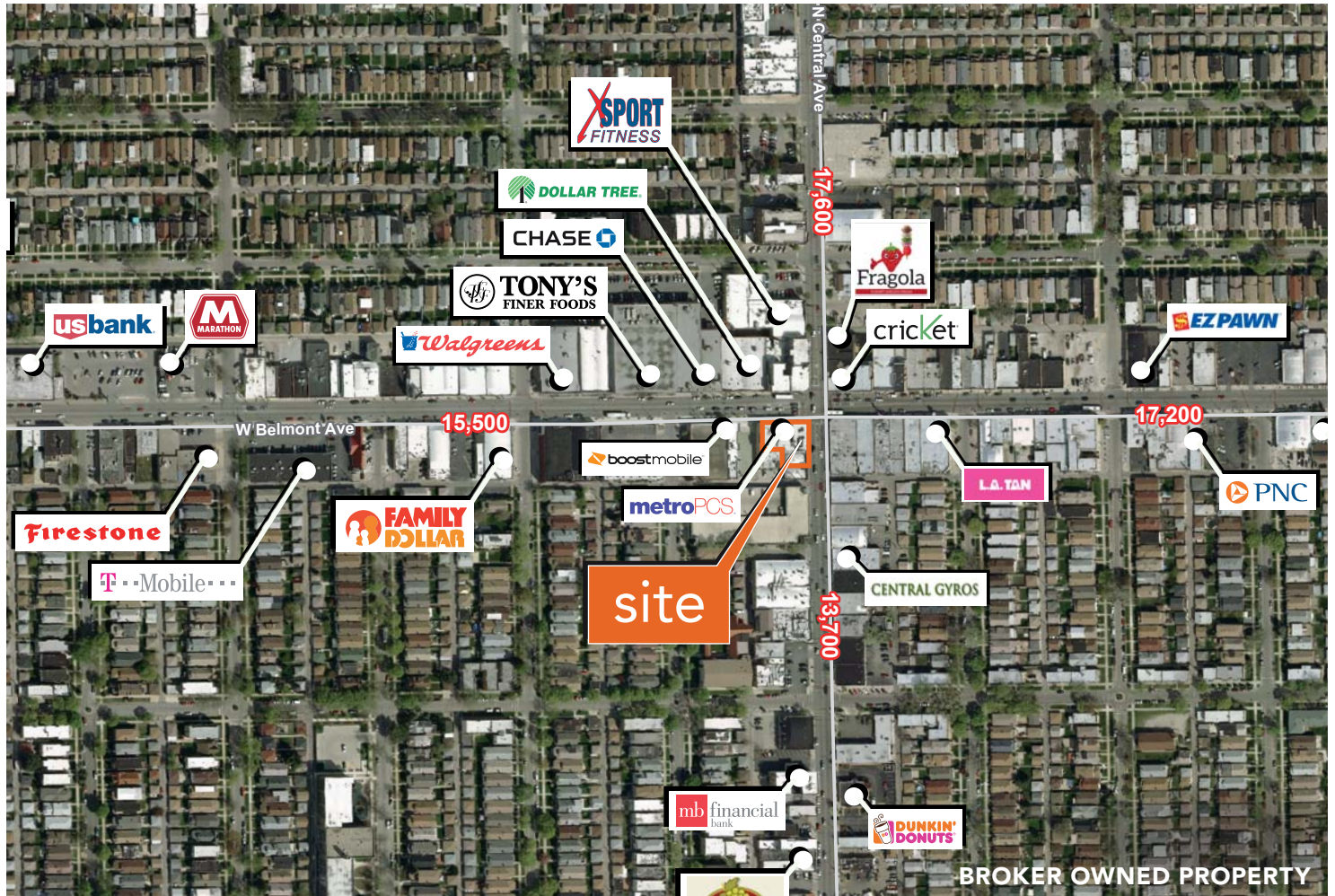

- ▶ Available space:
 - ±1,500 SF
 - ±3,000 SF
- ▶ Great retail location at the southwest corner of Belmont Avenue & Central Avenue in the Belmont-Cragin neighborhood
- ▶ Situated next to a free community parking garage
- ▶ Area retailers include Xsport Fitness, Chase Bank, Walgreens, Dollar Tree, Tony's Fresh Market and more
- ▶ **Incentives available**

DEMOGRAPHIC SUMMARY

	.25 Mile	.5 Mile	1 Mile
Estimated Population	3,847	15,434	66,490
Adj. Daytime Demographics	3,036	11,931	43,171
Estimated Households	1,180	4,720	19,586
Estimated Average Household Income	\$73,826	\$67,745	\$66,978

MARK FREDERICKS

mark@baumrealty.com
312.275.3109

TREVOR JACK

trevor@baumrealty.com
312.275.3128



© 2018 All information supplied is from sources deemed reliable and is furnished subject to errors, omissions, modifications, removal of the listing from sale or lease, and to any listing conditions, including the rates and manner of payment of commissions for particular offerings, the terms of which are available to principals or duly licensed brokers. Any square footage dimensions set forth are approximate.

5601 W. Belmont Avenue

CHICAGO, IL 60634 | BELMONT-CRAGIN

For Lease

RETAIL SPACE

W. Belmont Avenue

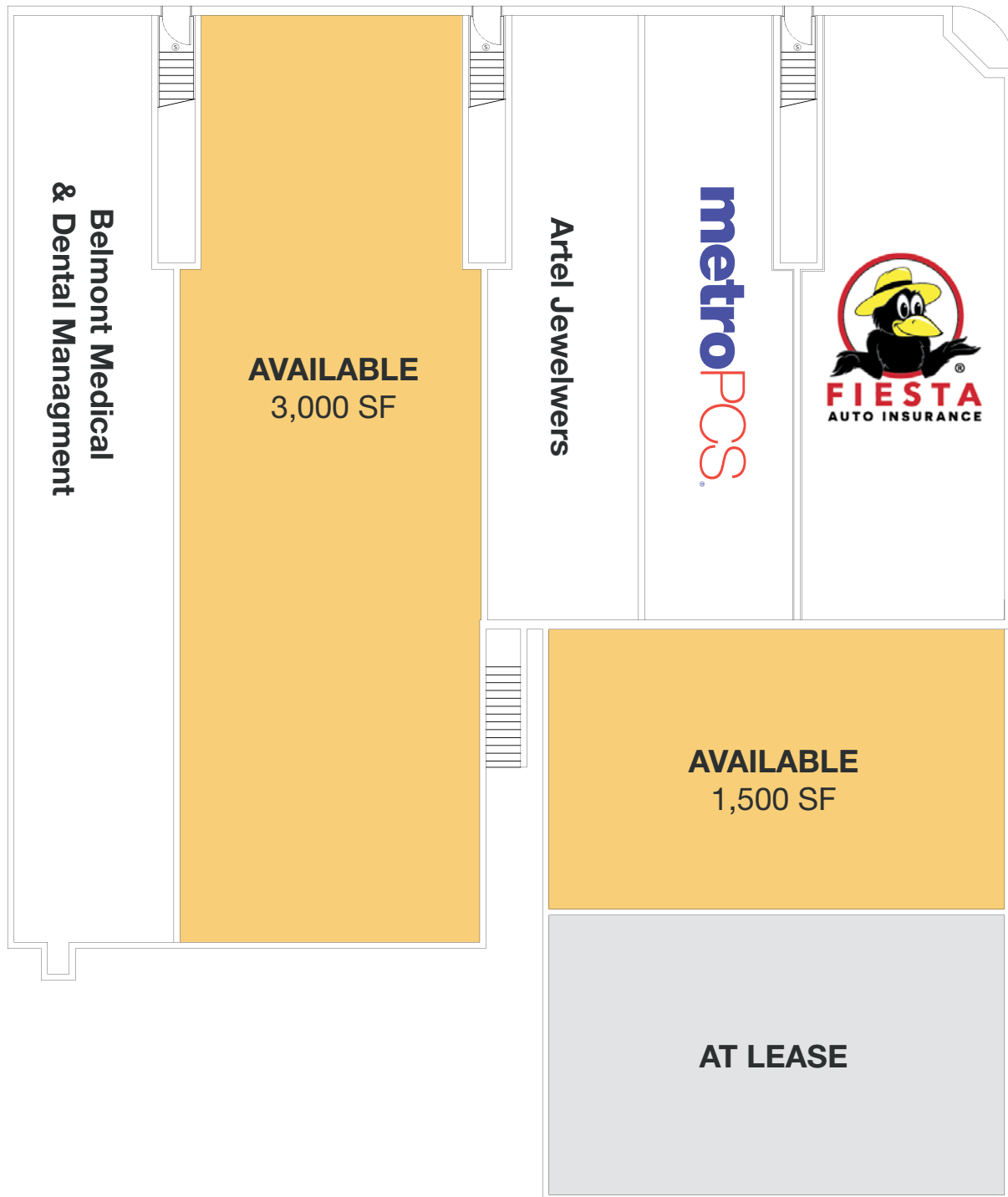

MARK FREDERICKS

mark@baumrealty.com

312.275.3109

TREVOR JACK

trevor@baumrealty.com

312.275.3128



© 2018 All information supplied is from sources deemed reliable and is furnished subject to errors, omissions, modifications, removal of the listing from sale or lease, and to any listing conditions, including the rates and manner of payment of commissions for particular offerings, the terms of which are available to principals or duly licensed brokers. Any square footage dimensions set forth are approximate.