

For Sale

Land Parcel

63rd St & S. Pulaski Rd

Chicago, IL 60629



- Adjacent to CVS Pharmacy
- Cross parking site with great visibility on a strong major VPD arterial Pulaski Rd - (43k VPD)
- Located in close proximity to Midway International Airport and in close proximity to several full service restaurants, QSR's, and hotels

DEMOGRAPHIC SUMMARY

	RADIUS		
	.25 MILE	.5 MILE	1 MILE
AVERAGE HHI	\$71,711	\$67,070	\$59,954
DAYTIME POPULATION	1,361	5,532	24,858
RESIDENTIAL POPULATION	3,340	13,828	52,981

TRAFFIC COUNTS

S. PULASKI RD	42,600 VPD
63 RD STREET	15,800 VPD

Doug Renner
312.275.3137
doug.renner@baumrealty.com



For Sale

Land Parcel

63rd St & S. Pulaski Rd

Chicago, IL 60629

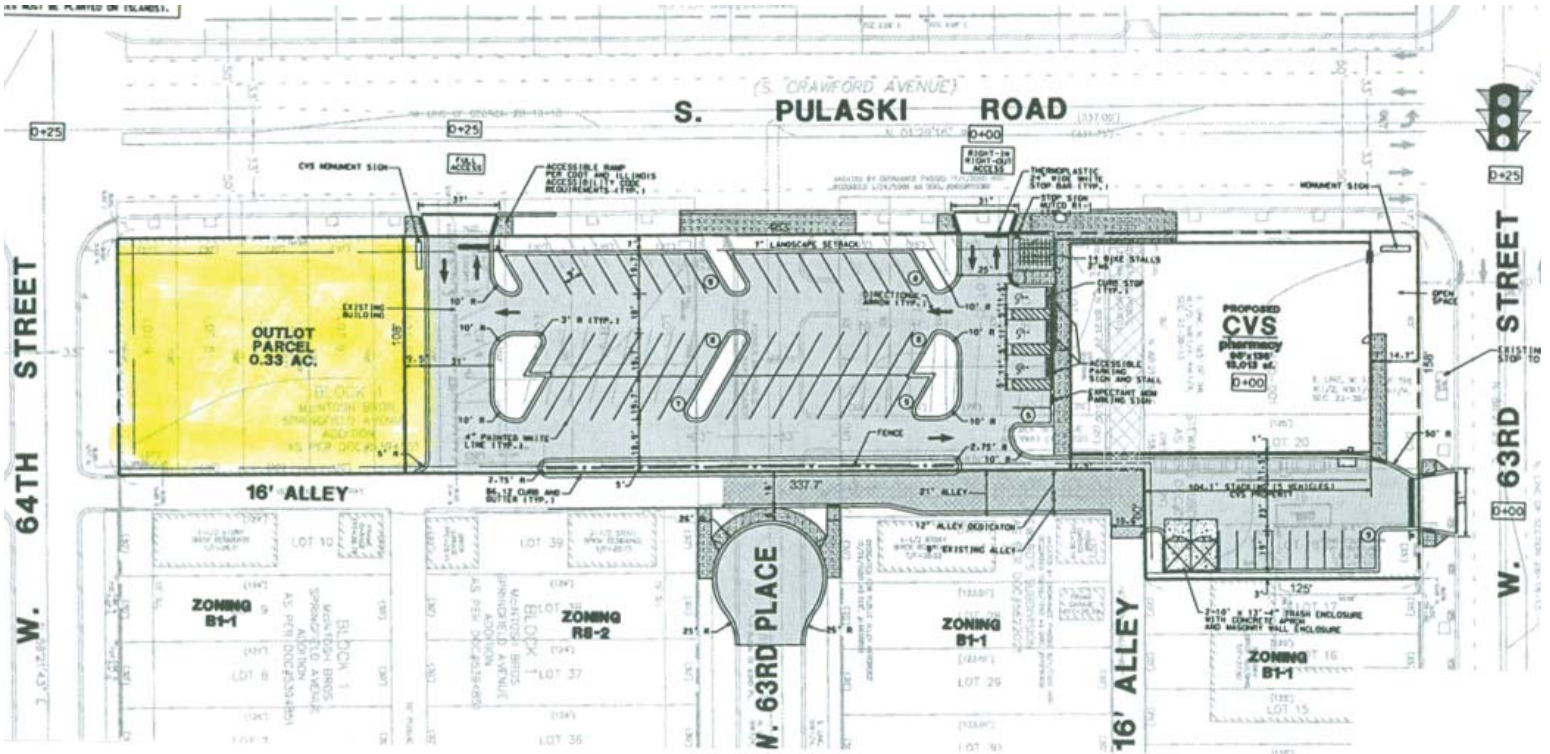

Doug Renner
312.275.3137
doug.renner@baumrealty.com



