

1735 N. DAMEN AVENUE

Prominent Bucktown Retail / Medical Space Available



Conceptual Rendering

For Leasing Information Contact:

Doug Renner

312.275.3137

doug.renner@baumrealty.com

Nicole Cardot

312.275.0371

nicole@baumrealty.com



1735 N. DAMEN AVENUE



PROMINENT BUCKTOWN RETAIL SPACE AVAILABLE

- ▶ **1,947 SF of ground floor retail available** in one of Chicago's hottest retail neighborhoods
- ▶ Move in ready boutique retail space
- ▶ 24' of frontage along Damen Avenue
- ▶ Competitive rental rates
- ▶ Opportunity for tenant designed facade
- ▶ Steps from The 606, Chicago's elevated trail & park system
- ▶ 3 parking spaces on-site
- ▶ Short term deals will be considered

DEMOGRAPHIC SUMMARY

	0.25 MI	0.5 MI	1 MI
AVERAGE HHI	\$177,789	\$147,116	\$123,459
DAYTIME POPULATION	2,454	11,963	35,164
RESIDENTIAL POPULATION	3,800	16,825	55,541

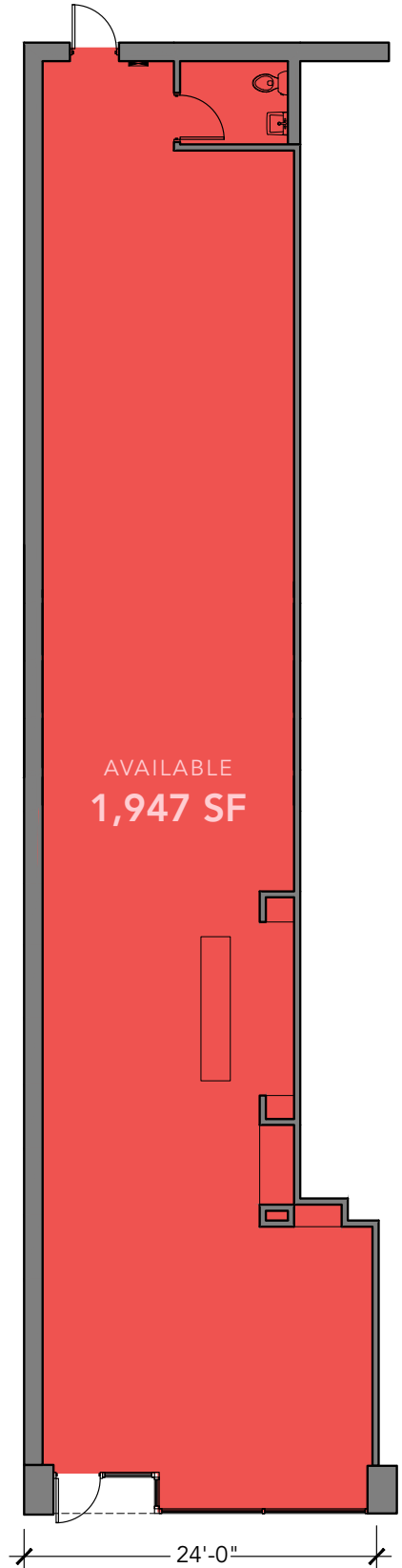

Doug Renner

312.275.3137

doug.renner@baumrealty.com

Nicole Cardot

312.275.0371

nicole@baumrealty.com



1735 N. DAMEN AVENUE



Conceptual Rendering

DAMEN AVENUE CO-TENANCY

1735 N. Damen Avenue is located along Chicago's most dynamic retail corridor. Damen Avenue boasts a diverse mix of vintage shops, independently owned boutiques, nationally recognized designers, fashion industry icons and major retailers. Recent entries to the market include Blue Mercury, Stadium Goods, and Big City Optical.

Aēsop. CLUB MONACO benefit
SAN FRANCISCO

lululemon athletica LUSH diptyque
FRESH HANDMADE COSMETICS paris FJALL RAVEN

SHINOLA bluemercury journelle THE NORTH FACE
makeup • skincare • spa

STADIUM GOODS ARCTERYX SCOTCH & SODA
AMSTERDAM COUTURE credo

Doug Renner

312.275.3137

doug.renner@baumrealty.com

Nicole Cardot

312.275.0371

nicole@baumrealty.com

BAUM
REALTY GROUP

1735 N. DAMEN AVENUE

Prominent Bucktown Retail / Medical Space Available

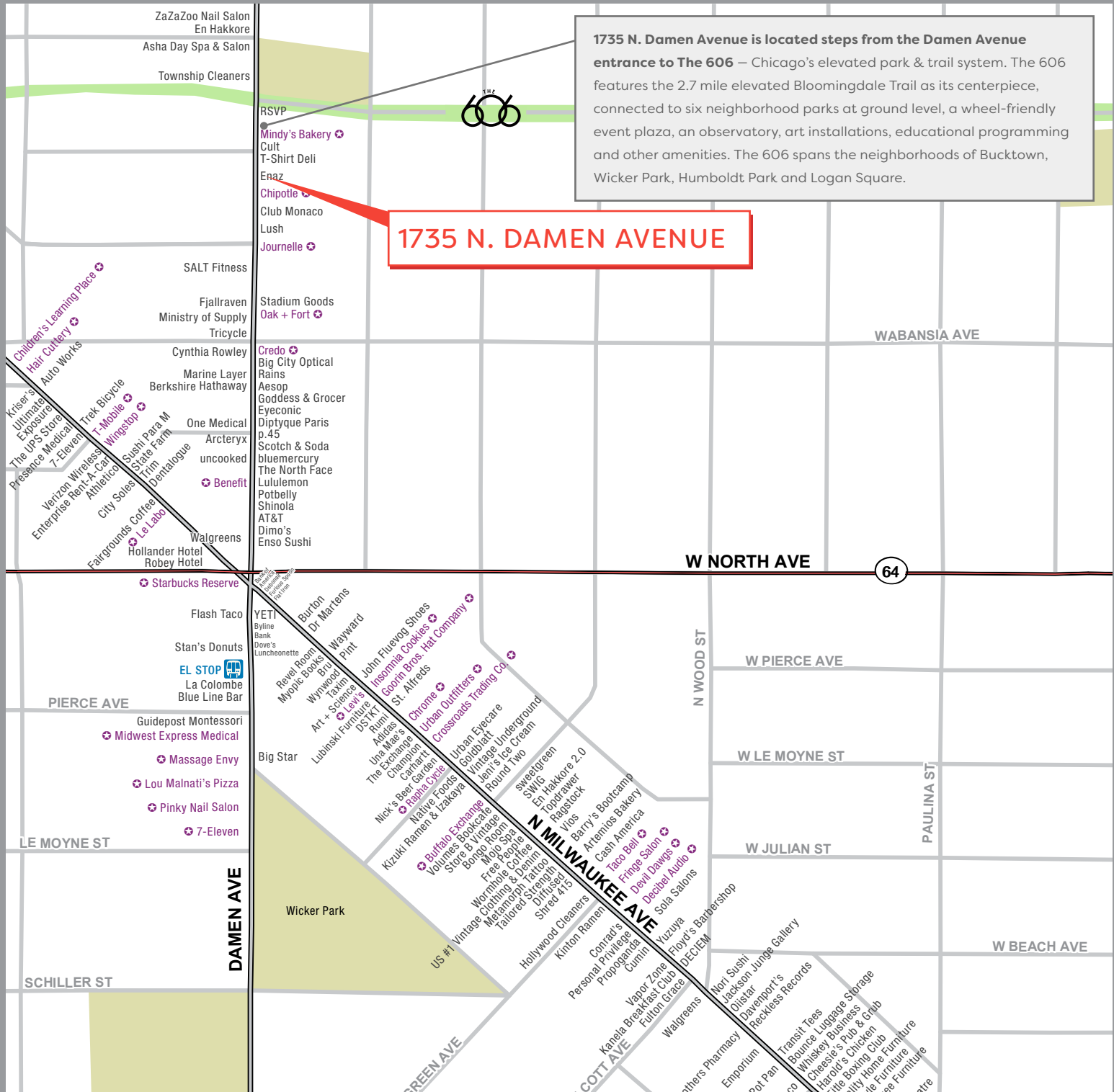

For Leasing Information Contact:

Doug Renner

312.275.3137

doug.renner@baumrealty.com

Nicole Cardot

312.275.0371

nicole@baumrealty.com

© 2021 All information supplied is from sources deemed reliable and is furnished subject to errors, omissions, modifications, removal of the listing from sale or lease, and to any listing conditions, including the rates and manner of payment of commissions for particular offerings, the terms of which are available to principals or duly licensed brokers. This information may include estimates and projections with respect to future events, and these future events may or may not actually occur. Such estimates and projections reflect various assumptions concerning anticipated results. While we believe these assumptions are reasonable, there can be no assurance that any of these estimates and projections will prove to have been correct. Therefore, actual results may vary materially from these forward-thinking estimates and projections. Any square footage dimensions set forth are approximate.

