

FOR LEASE

EVENT VENUE & OFFICE SPACE

758 W. North Avenue | Chicago, IL



FOR LEASING INFORMATION CONTACT

Lee Dickson

312.560.1432 | dickson@baumrealty.com

 **BAUM**
REALTY GROUP



Similar Chicago Venues



Logan Square Auditorium



Thalia Hall

A Hidden Gem

758 W. North Avenue's event venue is the city's best-kept secret, come discover it.

The second floor space features soaring two-story 22 ft ceilings, with 10 ft ceilings on the third floor mezzanine. The light filled fourth floor features 15 ft ceilings with few columns, making it an ideal home for your business or dance, music, acting, or children's theater training space. It can be divided to create the perfect environment.

Schedule a tour to imagine the possibilities.

- Individual zoned HVAC systems per floor. Heavy electric service. New washrooms planned for venue
- Tremendous signage opportunities
- The revered firm of Vinci Hamp Architects created the lobbies and vertical transportation, bringing the building up to all current ADA codes
- Located across the street from the CTA Red Line Clybourn station and the Brown/Purple Line Sedgwick station is minutes away
- 150 car parking lot at Lincoln Park Centre is located just across North Avenue, other nearby lots offer additional parking



Iconic Landmarked Building

758 W. NORTH AVENUE IS ON THE
NATIONAL REGISTER OF HISTORIC
PLACES AND IS DESIGNATED
A CHICAGO LANDMARK



Tremendous Signage Opportunities

VISIBLE TO 39,600 VPD WITH
FRONTAGE ON NORTH AVENUE AND
HALSTED STREET

Spectacular Event Venue

WITH ORIGINAL STAGE AND HISTORIC
ARCHITECTURAL DETAILS

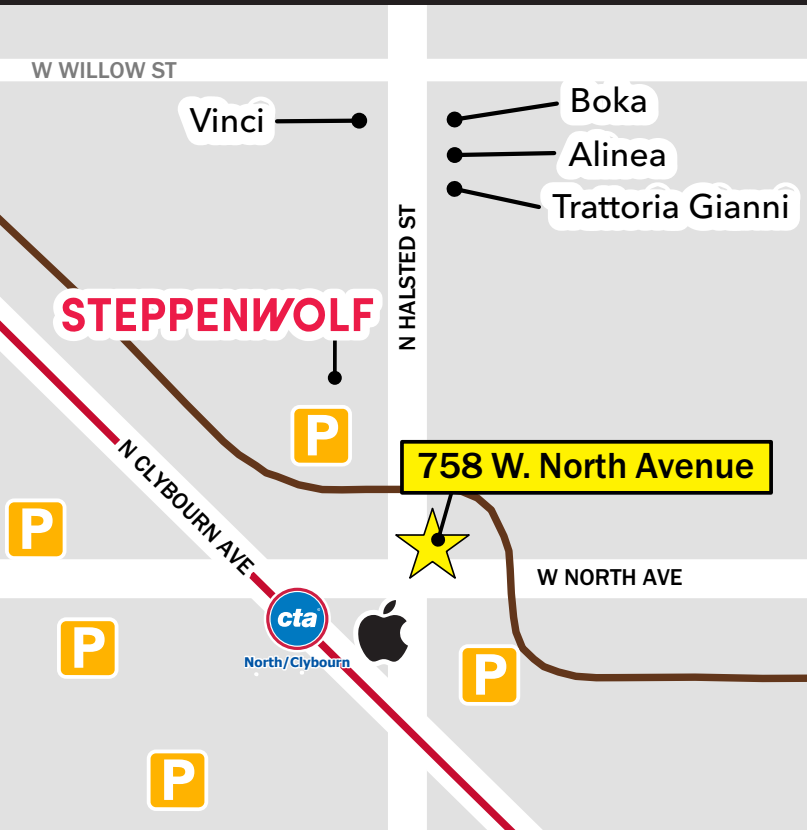

Steps from Parking, Public Transit, & Restaurants

ACROSS THE STREET FROM THE CTA
NORTH/CLYBOURN STATION & A 150
CAR PARKING GARAGE

2nd Floor - Event Space ▼

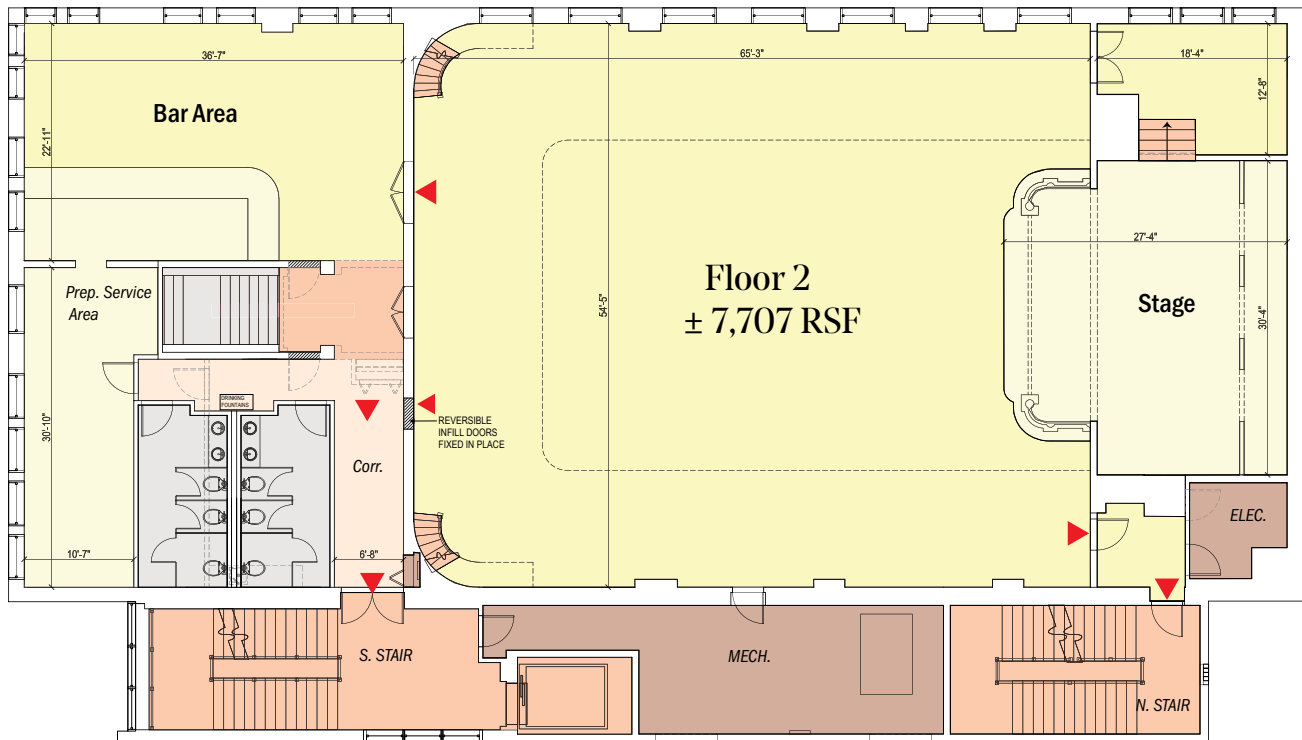

3rd Floor - Event Space ▼

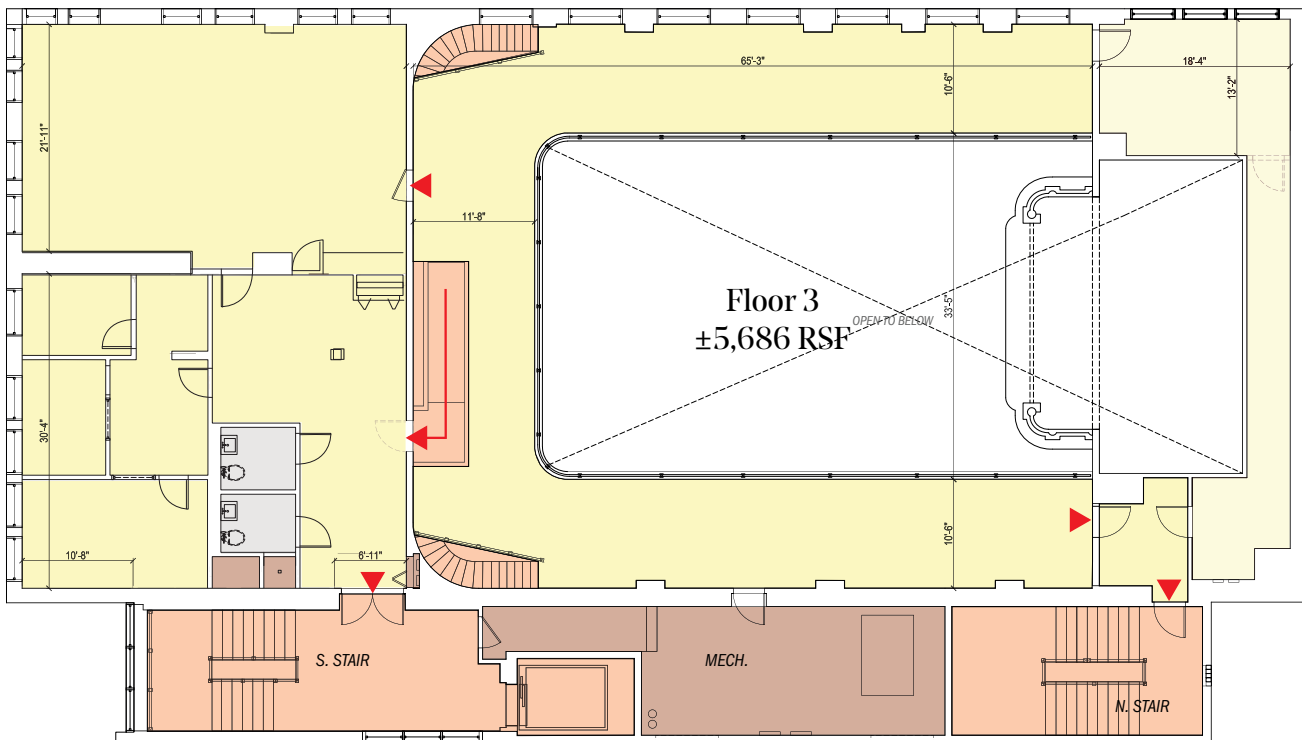



4th Floor - Option A - Multi-Tenant ▼

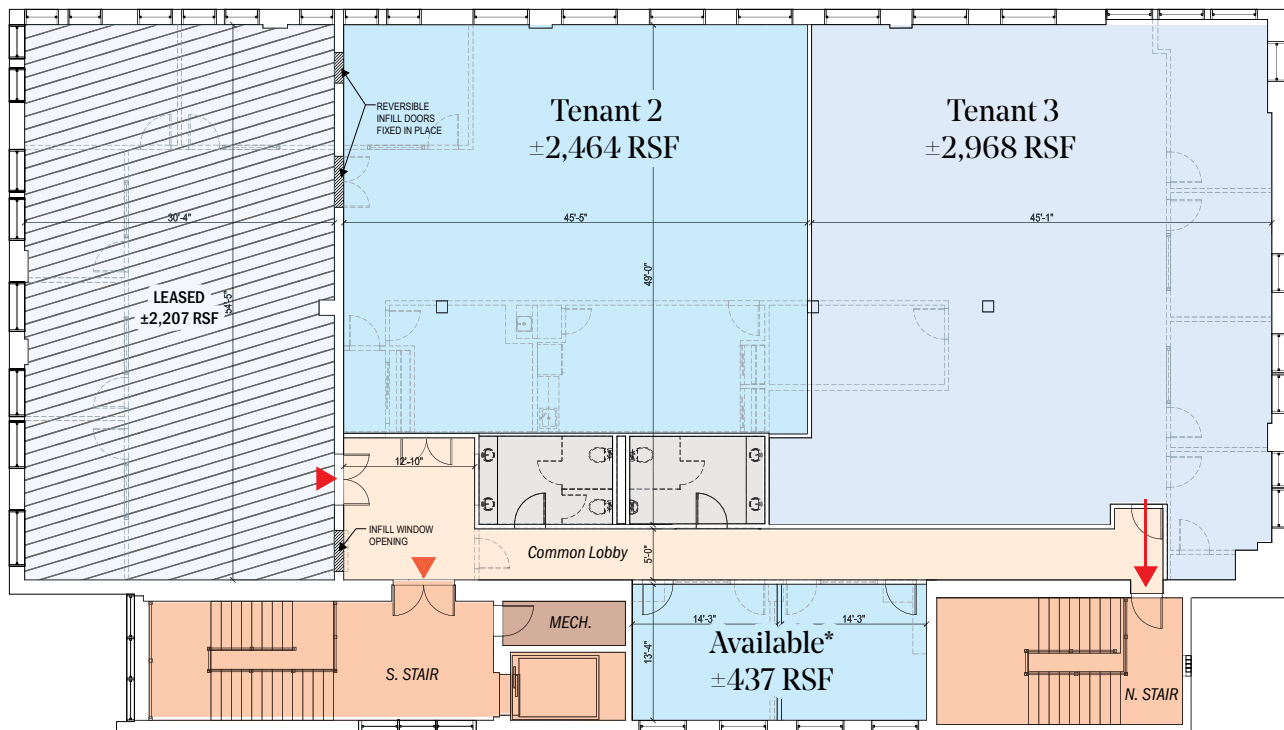

* Available ±437 SF space must be leased with one of the larger spaces.

4th Floor - Option B - Two Tenants ▼

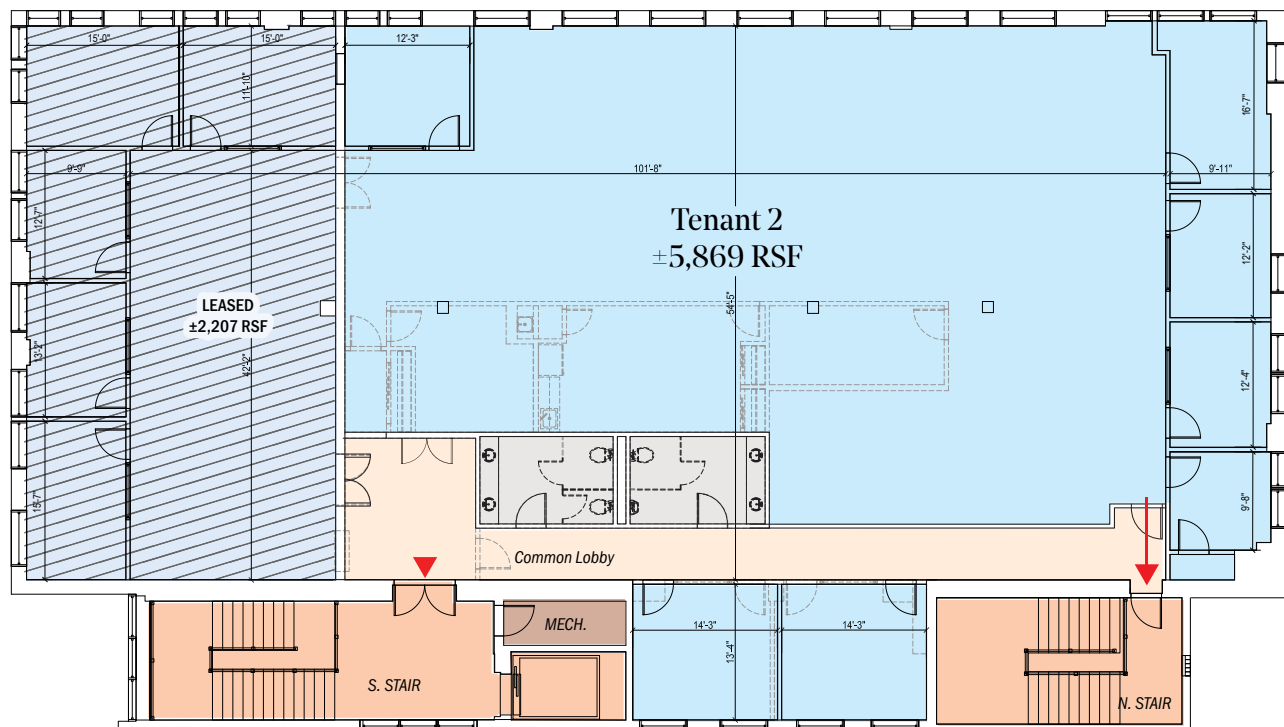



As-Is

Conceptual







▲ 4th floor features light filled space with few columns making it an ideal dance, music, acting, or children's theater training, rehearsal or office space.

◀ ADA compliant lobbies and vertical transportation by Vinci Hamp Architects on each floor.

WHO'S WHO

The area surrounding 758 W. North Avenue features a notable cast of entertainment, dining, and retail focused neighbors. To round out your experience, restaurants within easy walking distance include Vinci Restaurant, The Willow Room, Alinea, Boka, Trattoria Gianni, King Crab House, Summer House Santa Monica, Steppenwolf's Front Bar, Ramen-San, sweetgreen, Potbelly. Venues in the neighborhood include Steppenwolf's Downstairs Theater, its Ensemble Theater and the 1700 Theater, Steppenwolf's Merle Reskin Garage Theatre, the iO Theater, and Park West.

	STEPPENWOLF	CB2
	iO! THEATER	sweetgreen
		SUMMER HOUSE SANTA MONICA
NEWCITY LIFESTYLE & ENTERTAINMENT DISTRICT		VINCI
<i>The Second City</i>	PARK WEST	THE BARS AT STEPPENWOLF





758 W. North Avenue

LINCOLN PARK | CHICAGO, IL

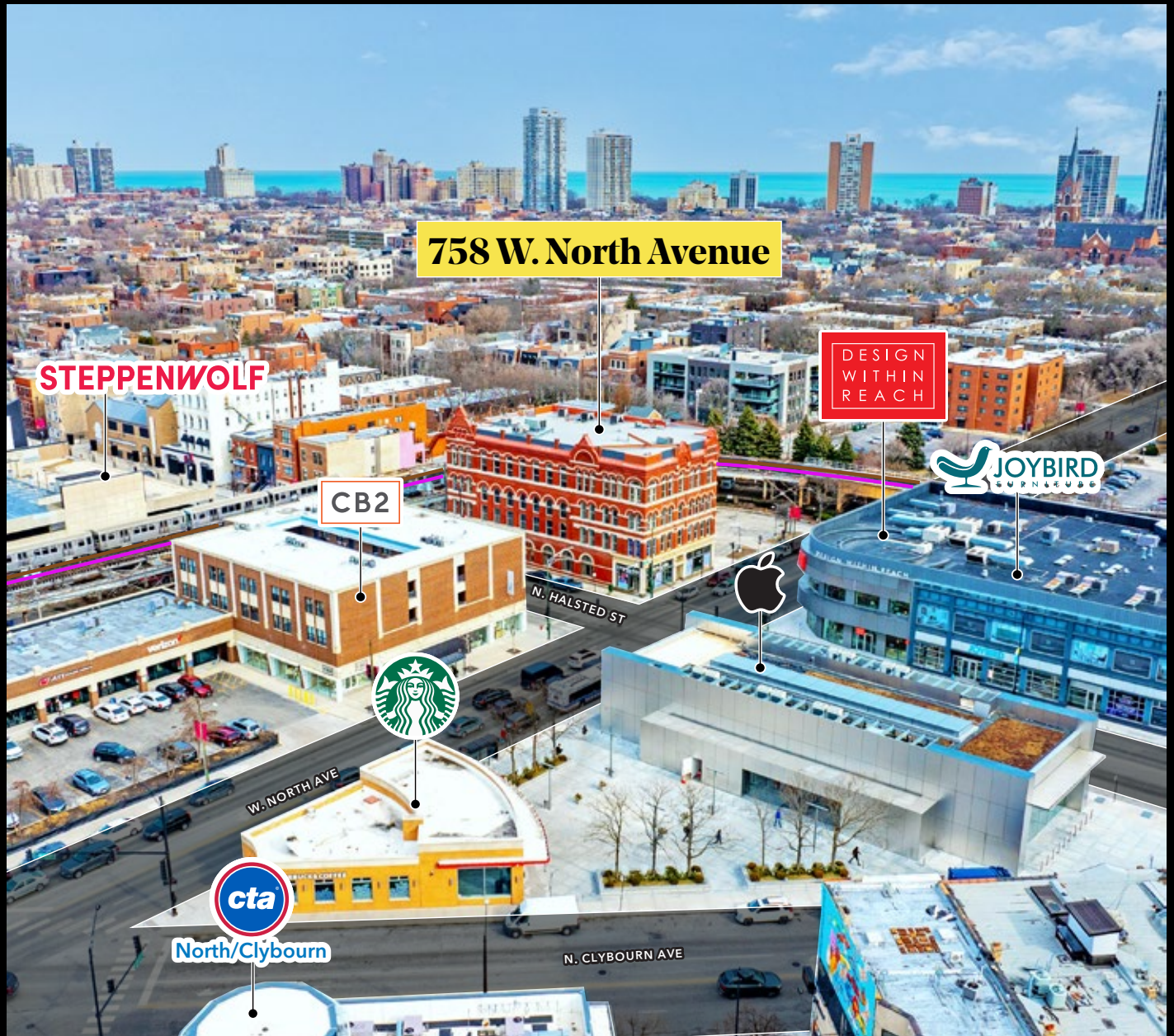

FOR LEASING INFORMATION CONTACT

Lee Dickson

312.560.1432

dickson@baumrealty.com



© 2025 All information supplied is from sources deemed reliable and is furnished subject to errors, omissions, modifications, removal of the listing from sale or lease, and to any listing conditions, including the rates and manner of payment of commissions for particular offerings, the terms of which are available to principals or duly licensed brokers. This information may include estimates and projections with respect to future events, and these future events may or may not actually occur. Such estimates and projections reflect various assumptions concerning anticipated results. While we believe these assumptions are reasonable, there can be no assurance that any of these estimates and projections will prove to have been correct. Therefore, actual results may vary materially from these forward-thinking estimates and projections. Any square footage dimensions set forth are approximate.